



CNX SERIES HYDRAULIC TORQUE TOOL

HexForce CNX is built to exceed the expectations of professionals seeking unmatched speed, durability, reliability, and user-friendliness in their bolting tasks. Constructed with high-strength aluminium. The HexForce CNX boasts exceptional strength and resilience. We prioritise operator comfort and ease of use with an ergonomic design that minimises fatigue and strain, while intuitive controls ensure smooth operation and error-free tightening.

The HexForce CNX series offers a versatile range of torque capacities and square drive sizes, effortlessly adapting to your specific needs.



High Strength Aerospace Aluminium Material

Ensures exceptional durability and lightweight handling.

One-Way Ratcheting Mechanism

Provides efficient fastening and accuracy.

Ratchet Freeing Mechanism

Allows for smooth and precise bolt loosening.

Multi-Axis 360°-180° Swivel

Offers unmatched versatility and access in confined spaces.

TORQUE RANGE **271-52500 FT.LBS.**
200-71180 NM

TORQUE TOOLS

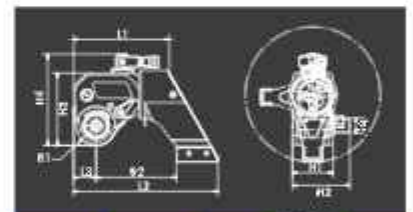

| MODEL | L1 (inch/ mm) | L2 (inch/ mm) | L3 (inch/ mm) | H1 (inch/ mm) | H2 (inch/ mm) | H3 (inch/ mm) | H4 (inch/ mm) | R1 (inch/ mm) | R2 (inch/ mm) | DRIVE SIZE | WEIGHT (lbs/ kg) | TORQUE (ft.lbs./Nm) | |
|--------|---------------------|---------------------|---------------------|---------------------|---------------------|---------------------|---------------------|---------------------|---------------------|---------------|------------------------|------------------------|-------|
| | | | | | | | | | | | | MIN. | MAX. |
| CNX-02 | 4.9 | 7.3 | 11 | 2.0 | 2.9 | 3.7 | 4.9 | 1.0 | 4.1 | 3/4" | 4.41 | 200 | 1339 |
| | 124 | 186.5 | 28.8 | 51.6 | 72.6 | 93.3 | 124.4 | 25 | 104.3 | | 2 | 271 | 1816 |
| CNX-04 | 6.4 | 9.7 | 15 | 2.7 | 3.7 | 4.8 | 6.4 | 1.3 | 5.3 | 1" | 10.36 | 479 | 3228 |
| | 161.9 | 245.5 | 39.1 | 68.8 | 94.4 | 121.2 | 162.1 | 33.3 | 135.2 | | 4.7 | 650 | 4377 |
| CNX-07 | 7.7 | 11.7 | 1.9 | 3.3 | 5.0 | 5.7 | 7.3 | 1.6 | 6.4 | 1 1/2" | 18.08 | 834 | 5587 |
| | 195.8 | 296.1 | 48.5 | 82.6 | 126.9 | 143.7 | 185.1 | 39.9 | 161.6 | | 8.2 | 1131 | 7575 |
| CNX-11 | 7.7 | 12.6 | - | 3.6" | 5.1 | 6.5 | 8.5 | 1.7 | 6.9 | 1 1/2" | 24.91 | 1200 | 8000 |
| | 195.6 | 319.3 | - | 90.7 | 129.3 | 165.1 | 215.9 | 44.7 | 176.8 | | 11.3 | 1627 | 10846 |
| CNX-15 | 9.6 | 14.4 | 2.3 | 4.1 | 5.7 | 7.2 | 9.1 | 2.0 | 8.0 | 1 1/2" | 33.07 | 1754 | 11513 |
| | 243 | 366.2 | 57.2 | 103.3 | 145.7 | 183.2 | 231.4 | 49.8 | 203.5 | | 15 | 2378 | 15610 |
| CNX-30 | 11.4 | 17.3 | 2.7 | 4.7 | 7.1 | 8.8 | 10.2 | 2.4 | 9.6 | 2 1/2" | 43.43 | 2958 | 19748 |
| | 289.8 | 438.7 | 68.8 | 120.1 | 180.3 | 223 | 260.1 | 59.9 | 243.3 | | 19.7 | 4011 | 26775 |
| CNX-35 | 11.8 | 18.5 | - | 5.2 | 7.5 | 9.6 | 11.5 | 2.6 | 10.2 | 2 1/2" | 68.56 | 3883 | 25890 |
| | 299.7 | 470.4 | - | 133.3 | 190 | 243.8 | 292.1 | 66.0 | 260.3 | | 31.1 | 5265 | 35102 |
| CNX-50 | 14.0 | 21.2 | 3.3 | 5.8 | 8.3 | 10.8 | 12.4 | 2.9 | 11.7 | 2 1/2" | 77.60 | 5397 | 37078 |
| | 356.3 | 539.2 | 84.6 | 147.8 | 211.3 | 274.1 | 313.9 | 73.7 | 298.2 | | 35.2 | 7317 | 50271 |
| CNX-72 | 15.5 | 23 | 3.7 | 6.6 | 9.4 | 11.0 | 12.8 | 3.3 | 12.8 | 2 1/2" | 124.34 | 7875 | 52500 |
| | 393.7 | 584 | 94 | 166.9 | 237.7 | 279.4 | 325.1 | 82.6 | 325.6 | | 56.4 | 10677 | 71180 |

*Minimum and maximum torque output data may vary.